

# ERA

## Decorative Window Handle Fitting Instructions

### Installing a Decorative Window Handle

To fit a window handle you will require the following tools:

- Screwdriver
- Hacksaw

#### Caution

Check that the dimension between the screw holes mirror your current handle to ensure the correct fit. The new handle has been pre-fitted with a 40mm long spindle. Measure the length of the existing spindle on the current handle (you will need to remove from the window, see below), then cut this spindle to the required length.

- To remove your existing handle, close your window and keeping the handle in the closed position. Remove the screw cover cap carefully to reveal the screw underneath and then remove. Push the button in and open the handle 90° to reveal the bottom screw hole and then remove the screw. Pull handle gently to remove.
- Keeping the new handle in the closed position. Insert the spindle (pre-cut to desired length) into the drive mechanism of your window lock. Cut the fixing screws to the required length, using a hacksaw (you can use your existing screws as a measuring guide). Then secure the top screw.
- Open handle 90° to reveal bottom screw hole and insert screw. Take care not to overtighten. Close handle to engage the mechanism and check operation. Attach the screw cover caps and close the handle.

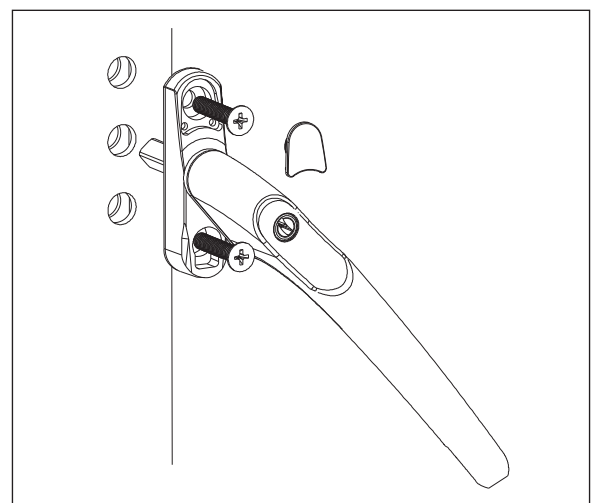
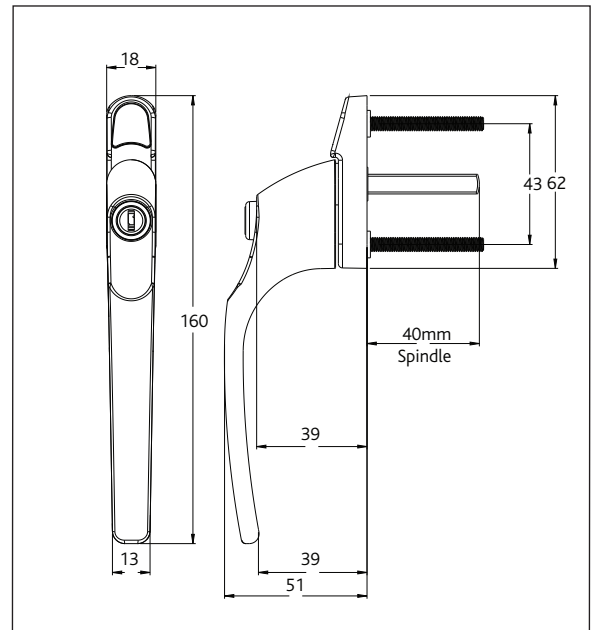

### Additional Information

**Please note:** This handle is only suitable for window locks operated by a handle with a spindle.

**Maintenance** - Handles should be cleaned with a soft dry cloth. If further cleaning is required we recommend a mild solution of warm, soapy water on a soft cloth. Dry thoroughly afterwards.

All dimensions are in mm and are nominal.  
ERA reserves the right to change specification without notice. It is the responsibility of the door manufacturer to ensure that the finished product meets any required safety and performance specification.