

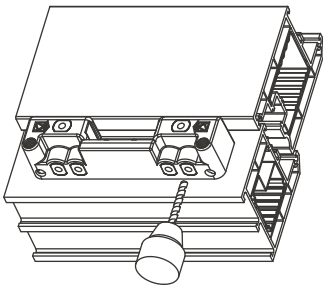

Challenger 3D Side Fix Butt Hinge PVCu Doors Fitting Instructions

Installing a Challenger 3D Butt Hinge

- 1** Lower the sash into the frame, ensure correct placement clamp if necessary. Drill pre-holes



- 2** Lift sash clear and fit the flag to the sash

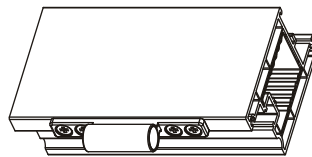

- 3** Lower the sash into the frame and clip jig under flag barrel. Drill two holes for hinge pins

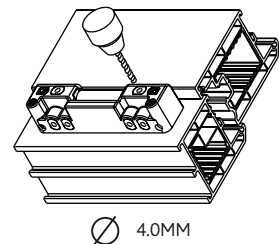

- 4** Lift the hinge clear, fit the hinge body and either pre-drill or fix with self drilling screws

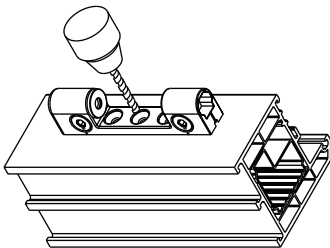

- 5** Fit the two main brushes into the flag barrel (Sprung bush to the top)

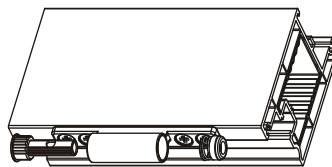

- 6** Lower the sash into the frame allowing the flag barrel to locate into the hinge body

Fit the hinge pin until the head is below the height of the top of the hinge body

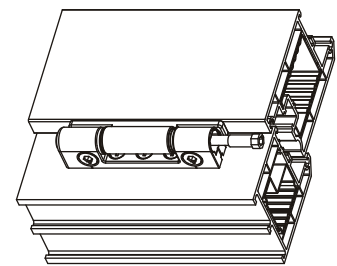

- 7** Lateral and vertical adjustment are pre-set. The hinge pin should be set so that the alignment mark points towards the sash

other adjustments can be made as necessary

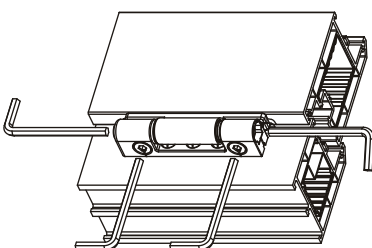

- 8** Fit cover caps if required. Top cap must be fitted as it locks the hinge pin in place

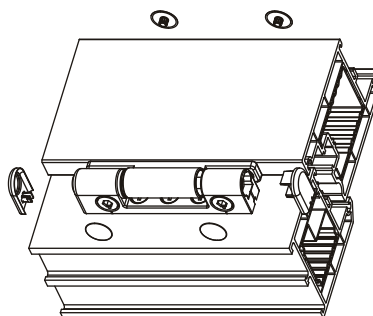

- 9** If required fit the security screw. Do not over-tighten

